

Kustomjee[®]
PINNACLE
BORIVALI (E)

Kustomjee[®]
PINNACLE
BORIVALI (E)



COSY, YET SPACIOUS.
AS CLOSE TO THE CITY
AS IT IS AWAY FROM IT.
LUXURIOUS, BUT AFFORDABLE.
AREN'T CONTRADICTIONS LOVELY?

In the heart of Borivali, Rustomjee Pinnacle is poised to deliver a new kind of lifestyle. Featuring 3 Bedroom homes that make the most of space, it offers thoughtfully designed amenities like a swimming pool, landscaped garden and kid's play area. Should you feel the need to step out, it is close to fine dining restaurants, multiplexes, cafés, boutiques and shopping malls, making it the perfect address for those who like to enjoy a quiet life and occasionally indulge in a not-so-quiet one.

LOCATION MAP

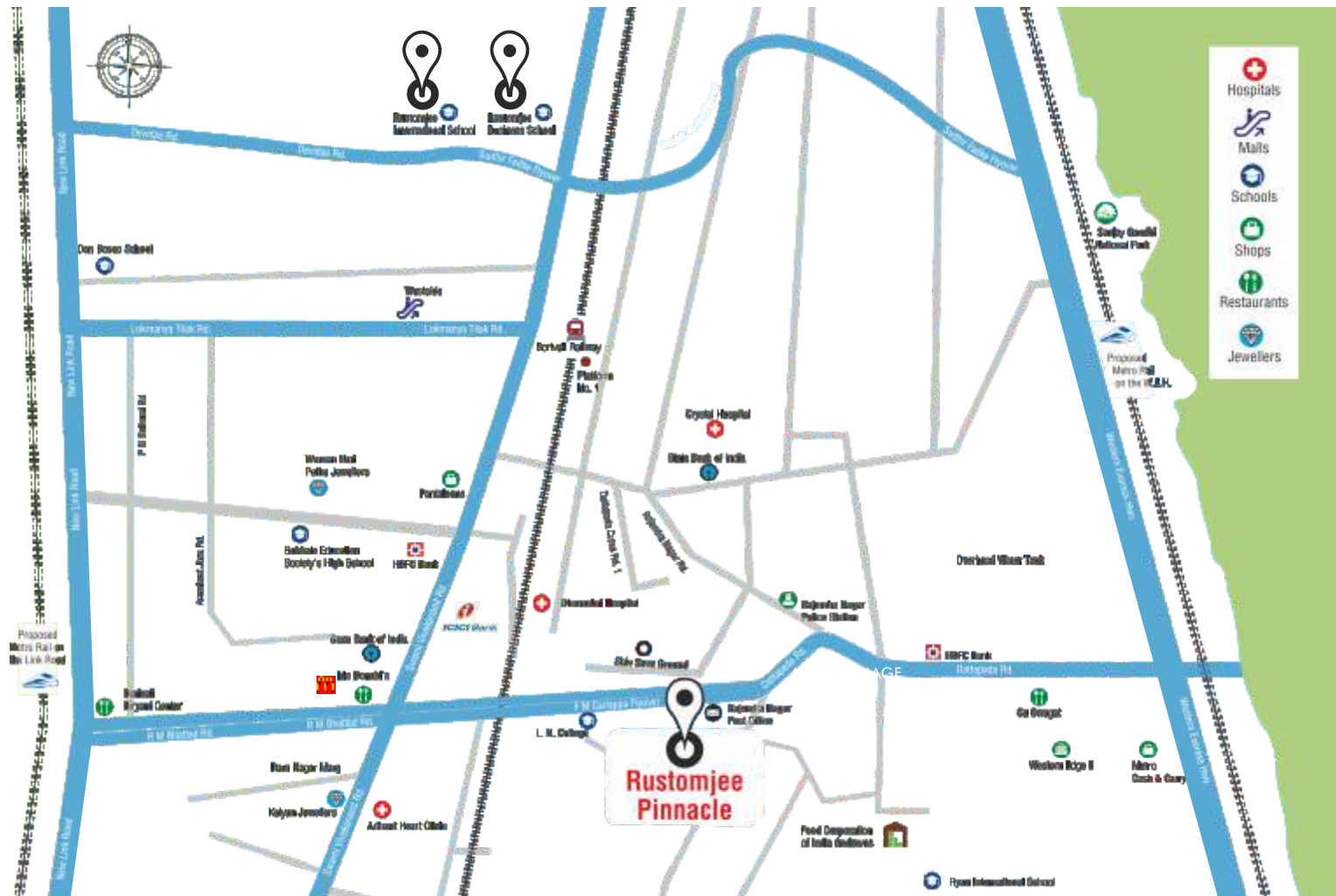

IN A CITY THAT DOESN'T UNDERSTAND THE CONCEPT OF PERSONAL SPACE, PRESENTING A HOME THAT DOES.

PROJECT HIGHLIGHTS:

- 🏠 Thoughtfully designed 3 bedroom apartments with Modular Kitchen.
- 🏠 Safety and security features.
- 🏠 All approvals received. Project nearing completion.
- 🏠 Located in the heart of Borivali.
- 🏠 Excellent connectivity to the Western Railway, proposed Metro Station and Western Express Highway.
- 🏠 Limited inventory available only for higher floors.

LAYOUT PLAN



GROUND FLOOR PLAN

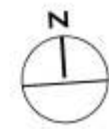

DISCLAIMER - 1. PLAN SUBJECT TO APPROVAL FROM MCGM & OTHER STATUTORY AUTHORITIES. 2. IN THE INTEREST OF CONTINUING IMPROVEMENT, THE PROMOTERS / DEVELOPERS RESERVE THE RIGHT TO ALTER THE PLANS, SPECIFICATIONS AND / OR FEATURES WITHOUT PRIOR NOTICE OR OBLIGATIONS. 3. ROOM DIMENSIONS INDICATED IN THE LEGEND ARE CONSIDERING UNFINISHED WALL SURFACES. 4. MINOR VARIATIONS (+ / -3%) IN ACTUAL CARPET AREAS MAY OCCUR AS A RESULT OF FINISHING TOLERANCES & COLUMN PROJECTIONS

ELEVATION



VIEW AND EXPERIENCE THE ARCHITECTURE

VIVEK SHUKLA ARCHITECTS PVT. LTD.

LIFESTYLE AMENITIES

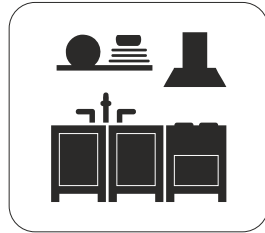

MODULAR KITCHEN

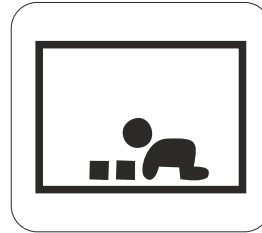

TODDLERS PLAY AREA



CCTV IN SELECT COMMON AREAS

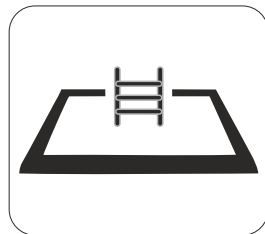

SWIMMING POOL

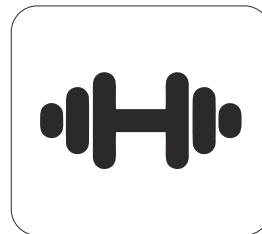

GYMNASIUM



VIDEO DOOR PHONE

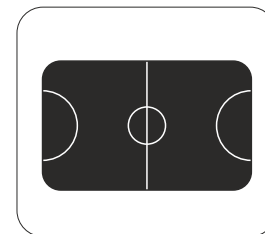

MULTI PLAY COURT*



ADEQUATE PARKING



MULTI FUNCTION ROOM

*Part of RG

ACTUAL DAY VIEWS
FROM THE SITE

At Pinnacle, Joy is always
on the horizon.



ACTUAL IMAGE

NORTH WEST

Sometimes, mother nature too,
has her favourites.



NORTH EAST

ACTUAL NIGHT VIEWS
FROM THE SITE

The city that never sleeps,
now at your feet.

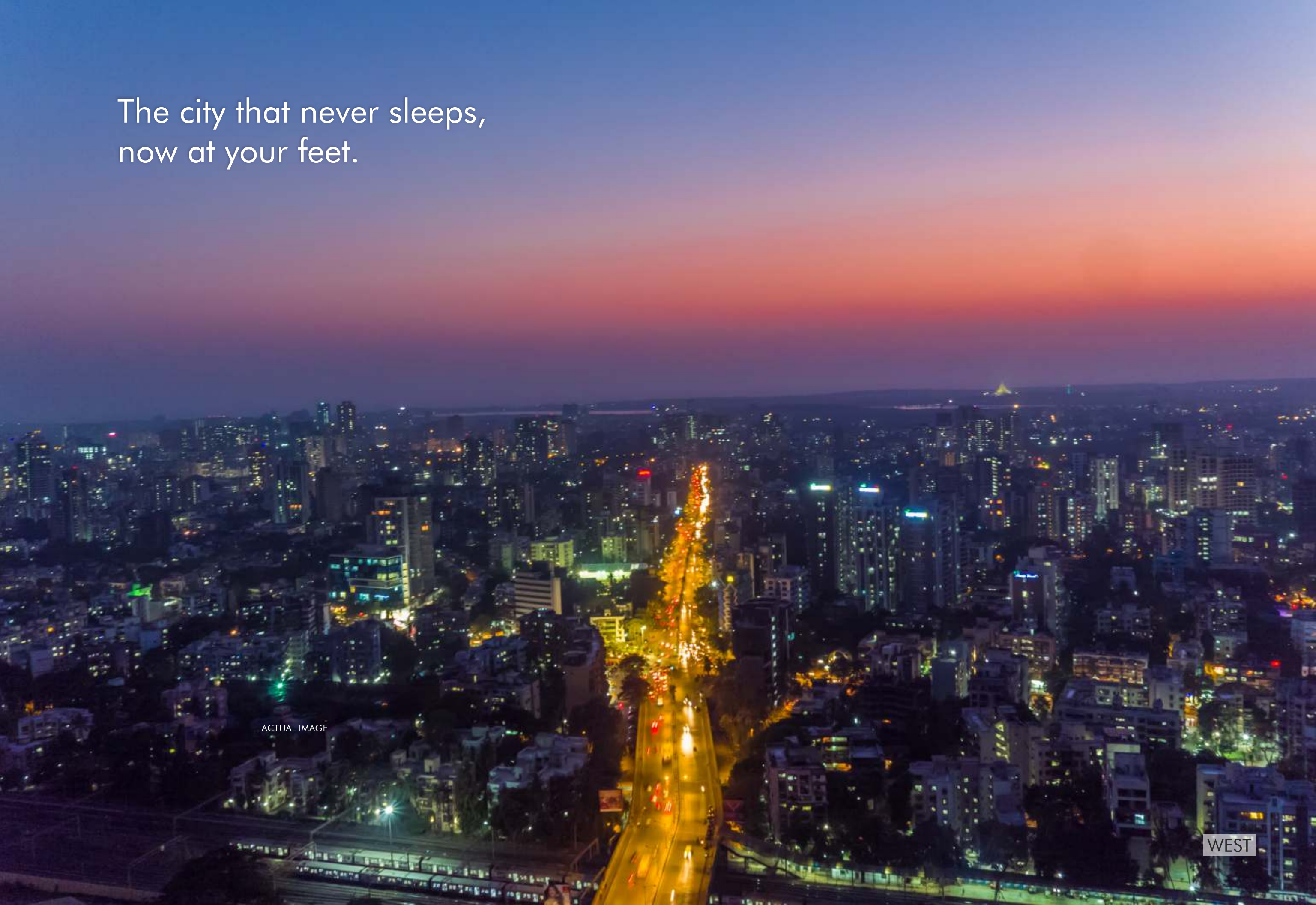

ACTUAL IMAGE

WEST

Pity you wont need those curtains
you took so long to choose.

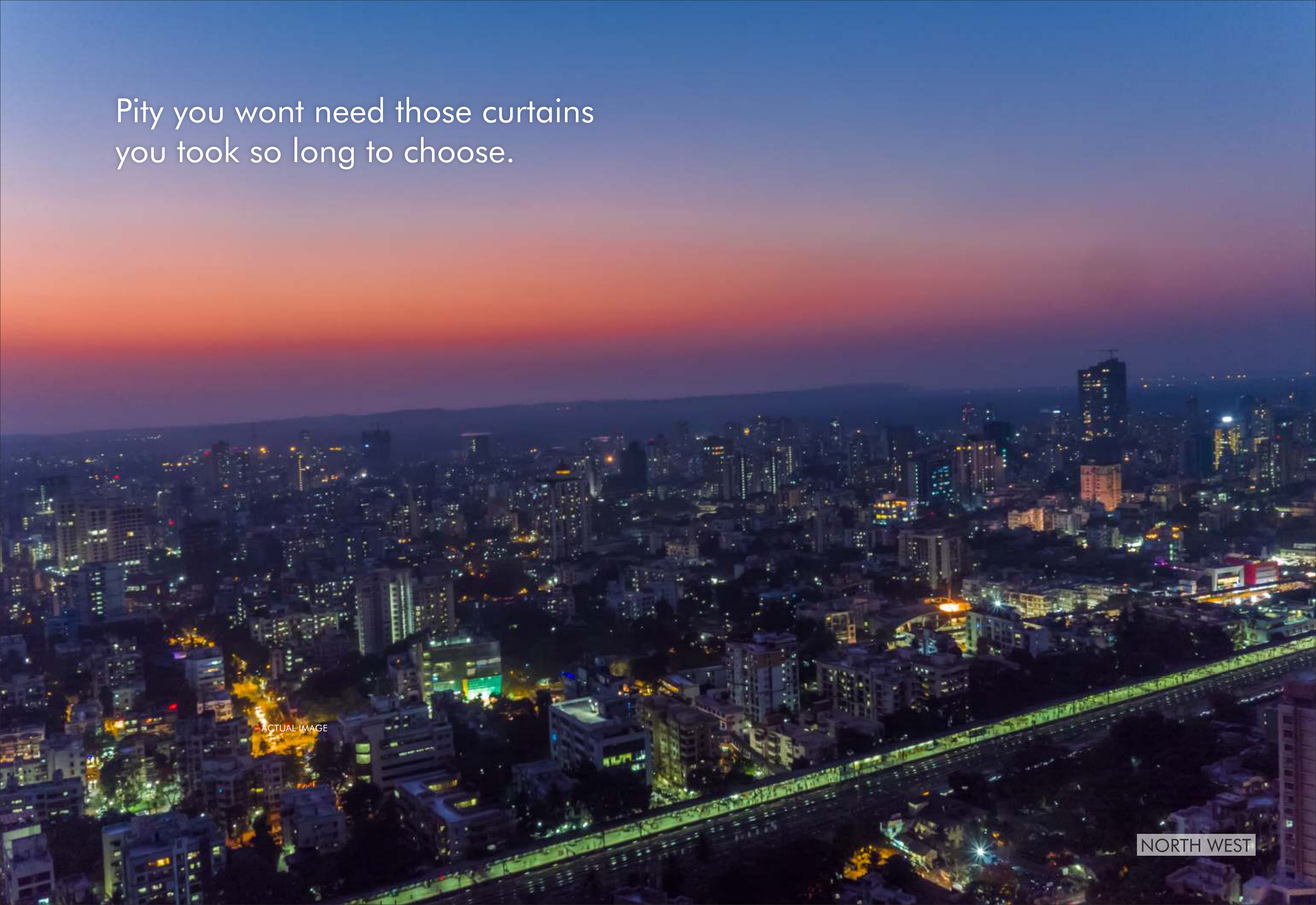

ACTUAL IMAGE

NORTH WEST

Maximum living in Maximum City.



EAST

FLOOR PLANS

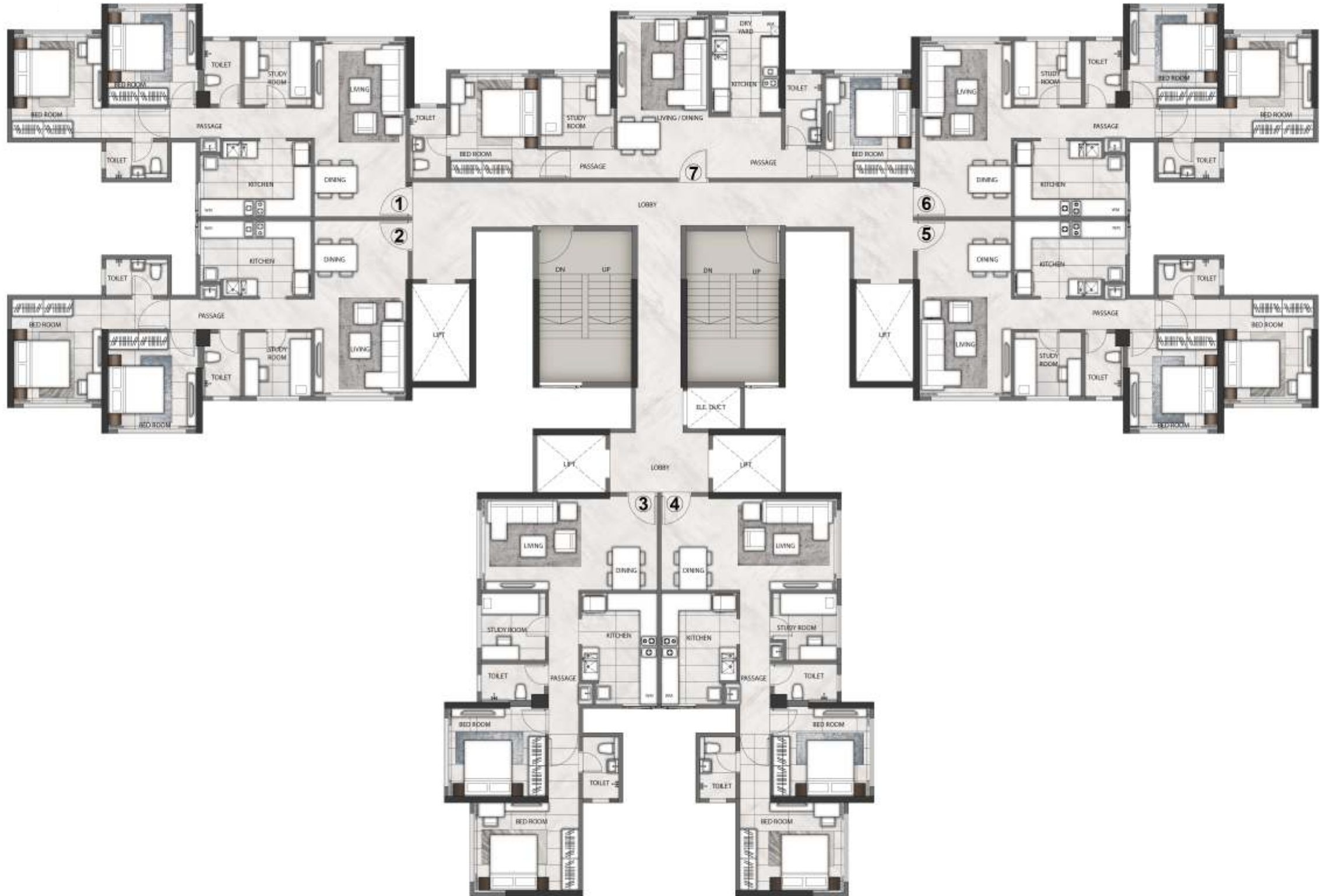

TYPICAL FLOOR PLAN

DISCLAIMER :- 1. ROOM DIMENSIONS & USABLE AREA INDICATED ARE MEASURED CONSIDERING UNFINISHED WALL SURFACES.
 2. MINOR VARIATIONS (+ / -3%) IN ACTUAL CARPET AREAS MAY OCCUR AS A RESULT OF FINISHING TOLERANCES & COLUMN PROJECTIONS
 3. THE FURNITURE FIXTURES & EQUIPMENTS (FF & E) INDICATED ABOVE DEPICTS PROPOSED INTERIOR ARRANGEMENT AS ENVISAGED BY THE ARCHITECT & IS NOT A PART OF THE PRODUCT OFFERING.



TYPICAL -FLAT 1/2/3/4/5/6

PARTICULARS (AS PER RERA)	SQ.MT.	SQ.FT.
CARPET AREA	74.36	800.41

	(METER)	(FEET)
1 LIVING & DINING	3.20 X 6.15	10'6" X 20'0"
2 STUDY ROOM	2.34 X 2.24	7'6" X 7'3"
3 MASTER BED ROOM	3.07 X 3.65	10'0" X 11'9"
4 MASTER TOILET	2.40 X 1.05	7'9" X 3'3"
5 PASSAGE	5.04 X 1.05	16'6" X 3'3"
6 KITCHEN	3.89 X 2.64	12'9" X 8'6"
7 NICHE	0.70 X 0.50	2'3" X 1'6"
8 BEDROOM - 1	3.07 X 3.39	10'0" X 11'0"
9 TOILET - 1	1.32 X 2.20	4'3" X 7'3"

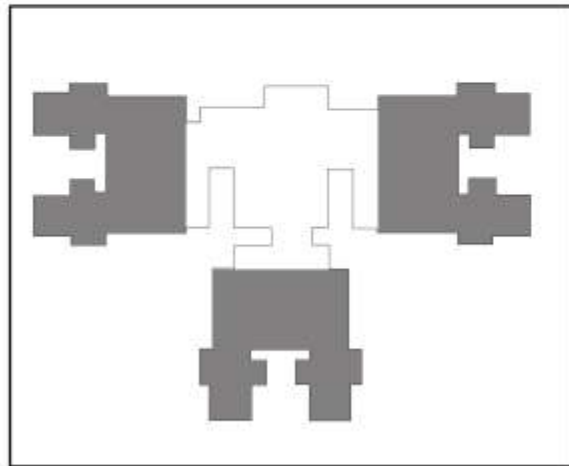

KEY PLAN FOR TYPICAL FLOOR
SCALE-NTS



DISCLAIMER :- 1. ROOM DIMENSIONS & USABLE AREA INDICATED ARE MEASURED CONSIDERING UNFINISHED WALL SURFACES.
 2. MINOR VARIATIONS (+ / -3%) IN ACTUAL CARPET AREAS MAY OCCUR AS A RESULT OF FINISHING TOLERANCES & COLUMN PROJECTIONS
 3. THE FURNITURE FIXTURES & EQUIPMENTS (FF & E) INDICATED ABOVE DEPICTS PROPOSED INTERIOR ARRANGEMENT AS ENVISAGED BY THE ARCHITECT & IS NOT A PART OF THE PRODUCT OFFERING.

TYPICAL UNIT-FLAT- 7

PARTICULARS (AS PER RERA)	SQ.MT.	SQ.FT.
CARPET AREA	74.36	800.41

	(METER)	(FEET)
1 LIVING & DINING	3.20 X 5.70	10'6" X 18'6"
2 STUDY ROOM	2.55 X 2.55	8'3" X 8'3"
3 MASTER BED ROOM	3.05 X 3.65	10'0" X 11'9"
	1.15 X 1.05	3'9" X 3'3"
4 MASTER TOILET	1.27 X 2.45	4'3" X 8'0"
5 PASSAGE	1.63 X 1.05	5'3" X 3'3"
6 KITCHEN	2.36 X 3.41	7'6" X 11'0"
7 LOBBY	2.55 X 2.13	8'3" X 6'9"
8 BEDROOM - 1	3.15 X 3.65	10'3" X 12'0"
	0.50 X 1.00	1'6" X 3'3"
9 TOILET - 1	1.25 X 2.50	4'0" X 8'3"
10 PASSAGE	0.90 X 1.00	2'9" X 3'3"

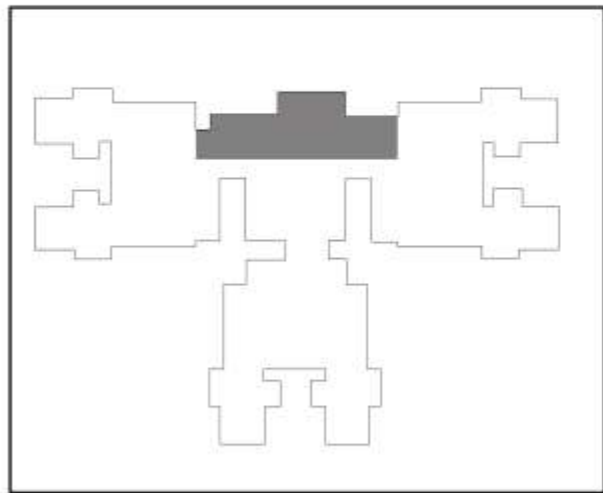

KEY PLAN FOR TYPICAL FLOOR
SCALE-NTS



DISCLAIMER :- 1. ROOM DIMENSIONS & USABLE AREA INDICATED ARE MEASURED CONSIDERING UNFINISHED WALL SURFACES.
 2. MINOR VARIATIONS (+ / -3%) IN ACTUAL CARPET AREAS MAY OCCUR AS A RESULT OF FINISHING TOLERANCES & COLUMN PROJECTIONS
 3. THE FURNITURE FIXTURES & EQUIPMENTS (FF & E) INDICATED ABOVE DEPICTS PROPOSED INTERIOR ARRANGEMENT AS ENVISAGED BY THE ARCHITECT & IS NOT A PART OF THE PRODUCT OFFERING.



SWIMMING POOL LEVELPLAN

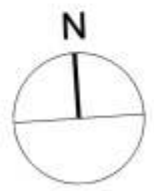

DISCLAIMER :- 1. PLAN SUBJECT TO APPROVAL FROM MCGM & OTHER STATUTORY AUTHORITIES . 2. IN THE INTEREST OF CONTINUING IMPROVEMENT, THE PROMOTERS / DEVELOPERS RESERVE THE RIGHT TO ALTER THE PLANS, SPECIFICATIONS AND / OR FEATURES WITHOUT PRIOR NOTICE OR OBLIGATIONS. 3. ROOM DIMENSIONS INDICATED IN THE LEGEND ARE CONSIDERING UNFINISHED WALL SURFACES. 4. MINOR VARIATIONS (+ / - 3%) IN ACTUAL CARPET AREAS MAY OCCUR AS A RESULT OF FINISHING TOLERANCES & COLUMN PROJECTIONS

IT'S THOUGHTFUL. IT'S **Rustomjee**[®]

CALL: 6111 6111 | SMS 'HOMES' TO 566778 | WWW.RUSTOMJEE.COM
SITE ADDRESS: RAJENDRA NAGAR, DATTAPADA ROAD,
NEAR BORIVALI EAST-WEST FLYOVER, BORIVALI (E), MUMBAI-400066
CORPORATE OFFICE: 702, NATRAJ BY RUSTOMJEE, M. V ROAD JUNCTION,
WESTERN EXPRESS HIGHWAY, ANDHERI (E), MUMBAI-400069.

Disclaimer: All layouts, locations, plans, specifications, designs, elevations, features, amenities, facilities, services, product/equipment type and brand mentioned are indicative of the kind of development proposed in this Project and its finality is subject to the approval of the respective authorities or as required by the Promoter/Developer in the interest of continuing improvement, without prior notice or obligation. Minor variations (+/- 3%) in actual carpet areas may occur as a result of design/construction variances, finishing tolerances and column projections. The pictures/images and perspective views of the premises/building/layout are on artist's impression of the development and for representational purposes only and are not a part of actual deliverables. Furniture, soft furnishing, gadgets, etc. are not part of the offering. The details, pictures and images contained in the leaflets, brochures or any other printed material does not constitute an offer and/or contract of any type between the Promoter/Developer and the Purchaser. All transactions in respect of this Project shall be subject to the terms and conditions of the Agreement for Sale to be entered into between the Promoter/Developer and the Purchaser. The property is mortgaged with IDBI Trusteeship Services Limited, who is acting as a Debenture Trustee for Piramal Finance Ltd. Bank Limited. The No Objection Certificate/permission of the mortgagee bank/institution would be provided to the Purchaser for the sale of flats/units, if required.